

DRAFT PLAN OF
STANDARD CONDOMINIUM
OF PART OF
BLOCK 66, PLAN 11M-247
AND PART OF
BLOCK 61, PLAN 11M-259
IN THE
MUNICIPALITY OF CENTRAL ELGIN
COUNTY OF ELGIN

MTE OLS LTD.
ONTARIO LAND SURVEYORS

METRIC:
DISTANCES AND COORDINATES SHOWN ON THIS PLAN ARE IN METRES AND CAN BE CONVERTED TO FEET BY DIVIDING BY 0.3048.
AREAS SHOWN ON THIS PLAN ARE IN SQUARE METRES AND CAN BE CONVERTED TO SQUARE FEET BY MULTIPLYING BY 10.7639

ADDITIONAL INFORMATION
REQUIREMENTS UNDER SECTION 51(17) OF THE PLANNING ACT

- A) AS SHOWN ON PLAN
- B) AS SHOWN ON PLAN
- C) AS SHOWN ON KEY PLAN
- D) MULTI FAMILY RESIDENTIAL
- E) AS SHOWN ON PLAN
- F) AS SHOWN ON PLAN
- G) AS SHOWN ON PLAN
- H) PIPED WATER
- I) SAND
- J) AS SHOWN ON PLAN
- K) FULL SERVICE
- L) AS SHOWN ON PLAN

LAND USE SCHEDULE
SITE - 7740.7 SQ.M (0.774 HECTARE)
BUILDING - 1634.5 SQ.M (0.183 HECTARE)
NUMBER OF UNITS - 219 (88 RESIDENTIAL, 82 PARKING, 69 STORAGE)
UNITS PER HECTARE - 282.9
GUEST PARKING - 24 (6 BARRIER FREE)

OWNER'S CERTIFICATE
I HEREBY AUTHORIZE THE FIRM OF MTE OLS LTD TO SUBMIT THIS PROPOSED PLAN OF CONDOMINIUM.

4024-01-10 DATE
WASTEL BUILDERS INC.
KOKOMO CONDOMINIUMS
THE PROMENADE - PORT STANLEY
WASTELL DEVELOPMENTS INC.

SURVEYOR'S CERTIFICATE
WE HEREBY CERTIFY THAT THE BOUNDARIES OF THE LAND TO BE SUBDIVIDED AS SHOWN ON THE PLAN AND THEIR RELATIONSHIP TO ADJACENT LANDS ARE ACCURATELY AND CORRECTLY SHOWN.

Jan 18, 2024 DATE
P.R. LEVAC
ONTARIO LAND SURVEYOR

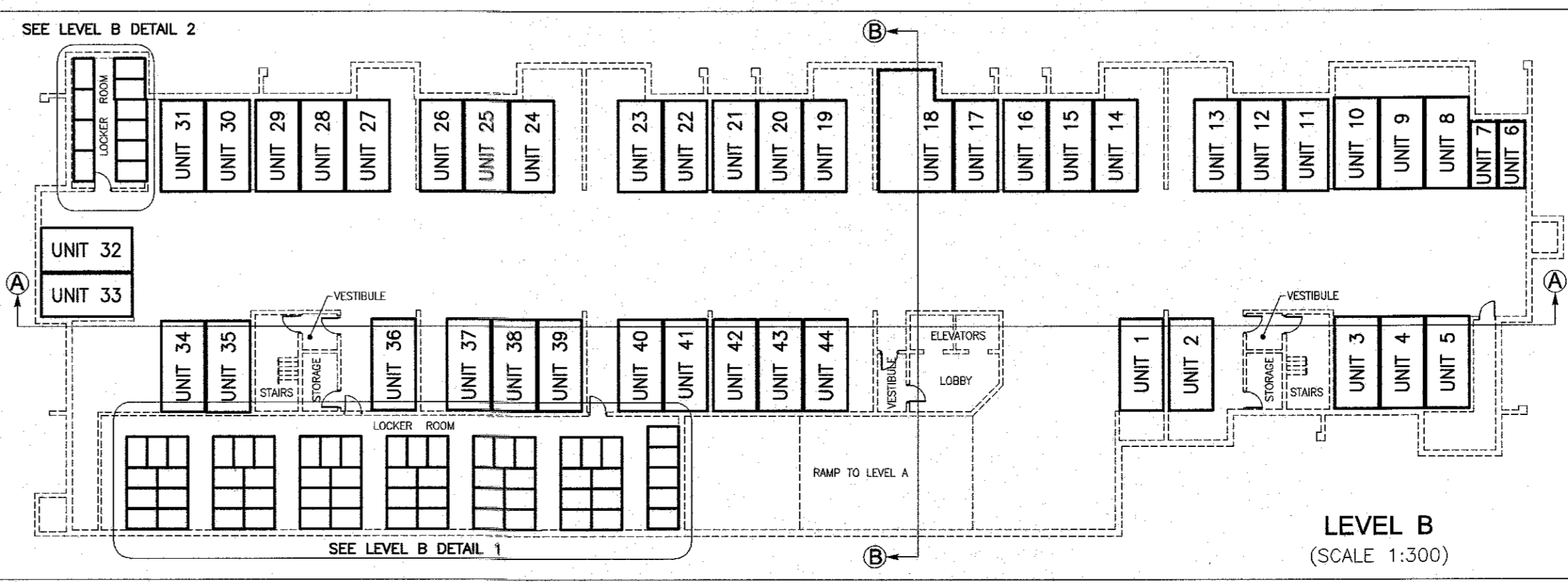
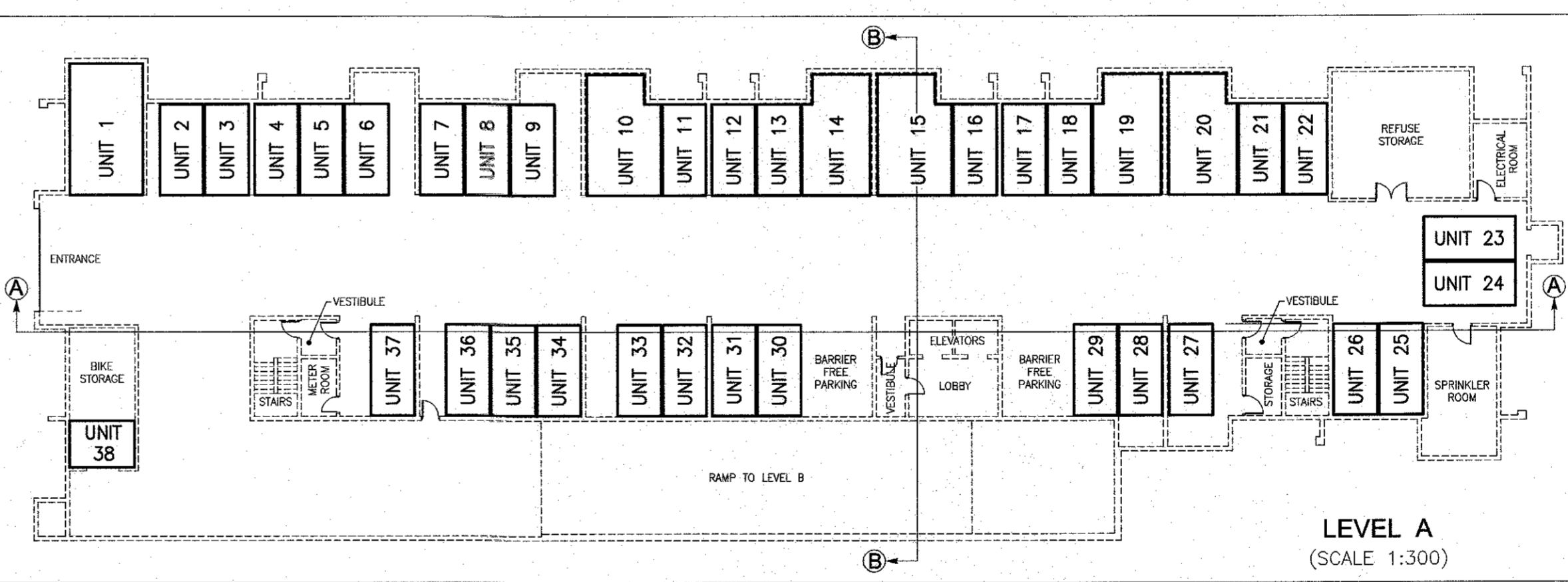
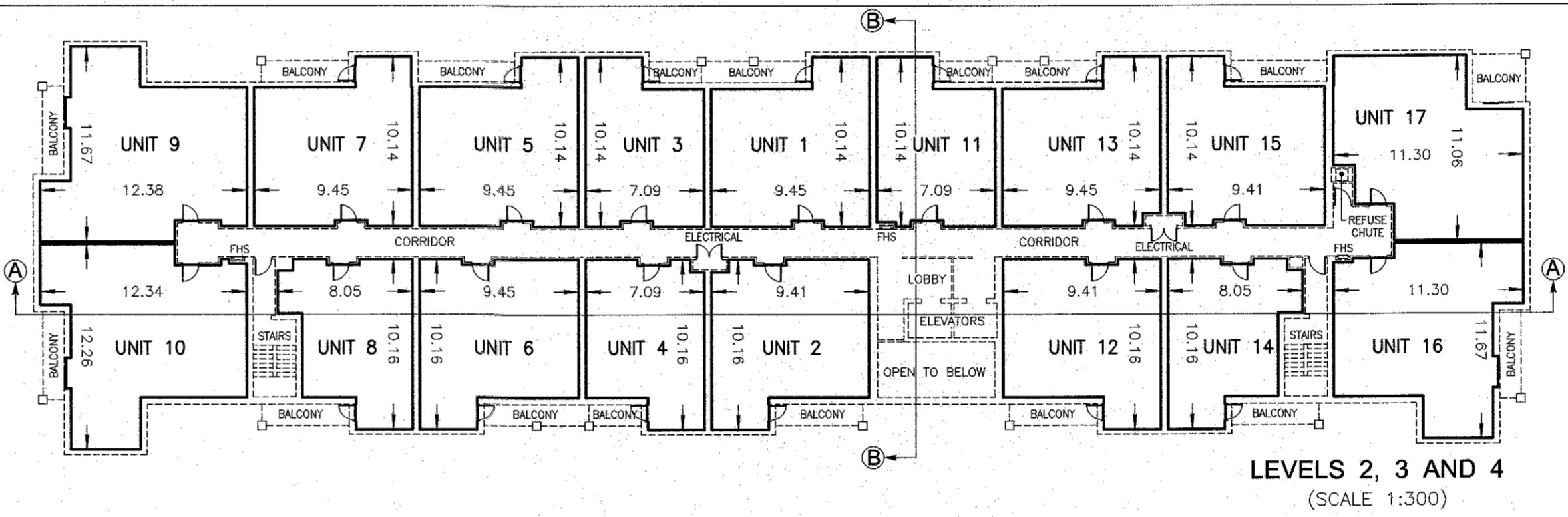

File: P:\P\41703\114\114-01.dwg last saved by DLCS, lastsave: 1/18/2024 1:34:32 PM, plot page size: PREVIOUS PAPER SIZE: (298.00 X 841.00 MM)

MTE ONTARIO LAND SURVEYORS LTD.
123 ST. GEORGE STREET
LONDON, ONTARIO, N6A 3A1
TEL: 519-204-6510

Surveyed By: *
Checked By: PRL
Drawn By: DL
Date: JAN 17 2024
File No: 41703-114